

Lj03

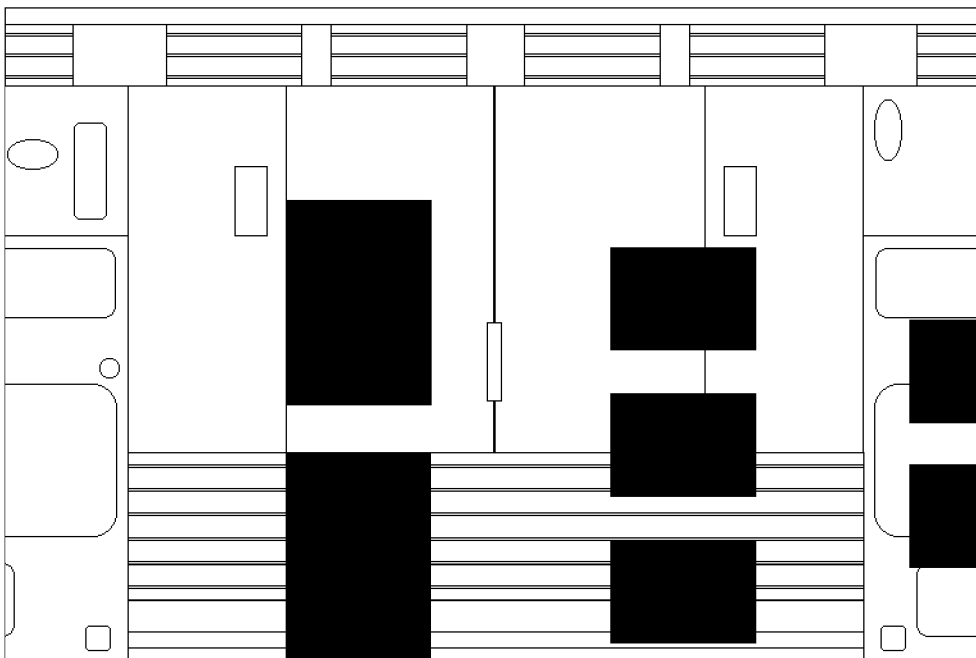

Lj04

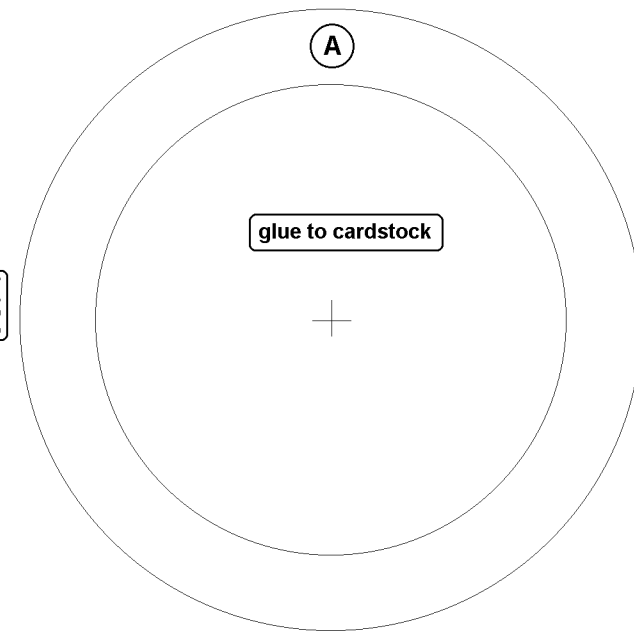

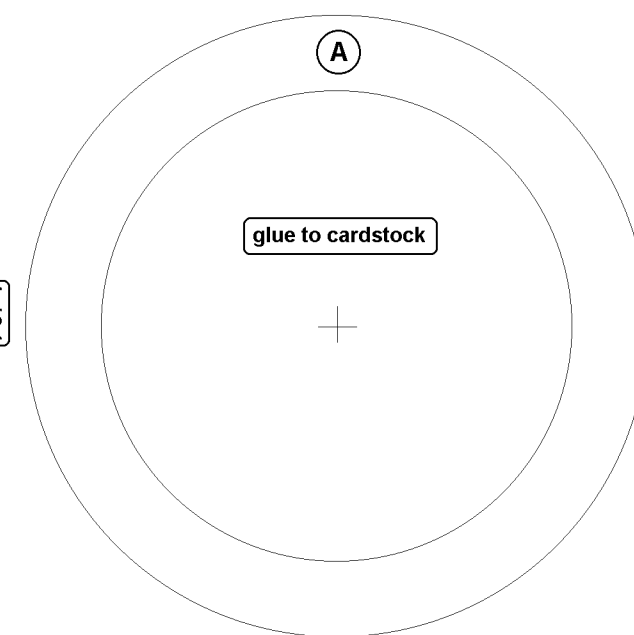
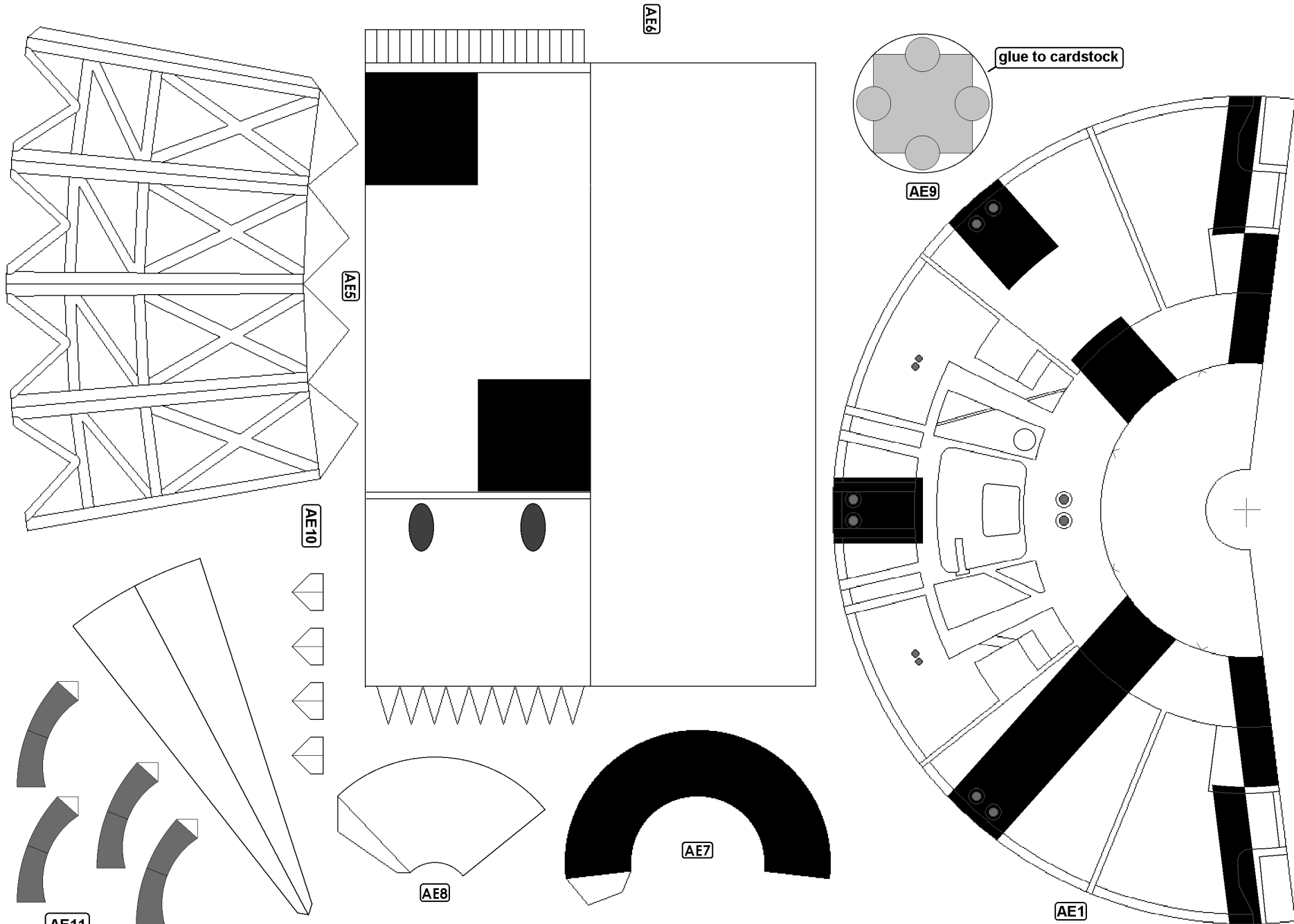

little Joe 2

LJ07

only score midflap

LJ06

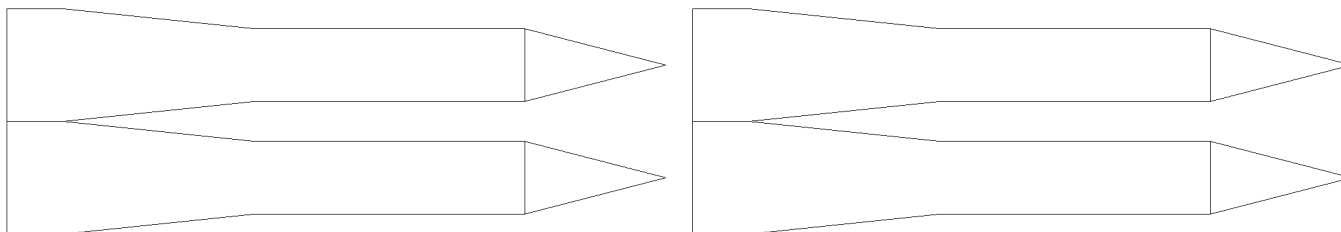

glue to cardstock

LJ05

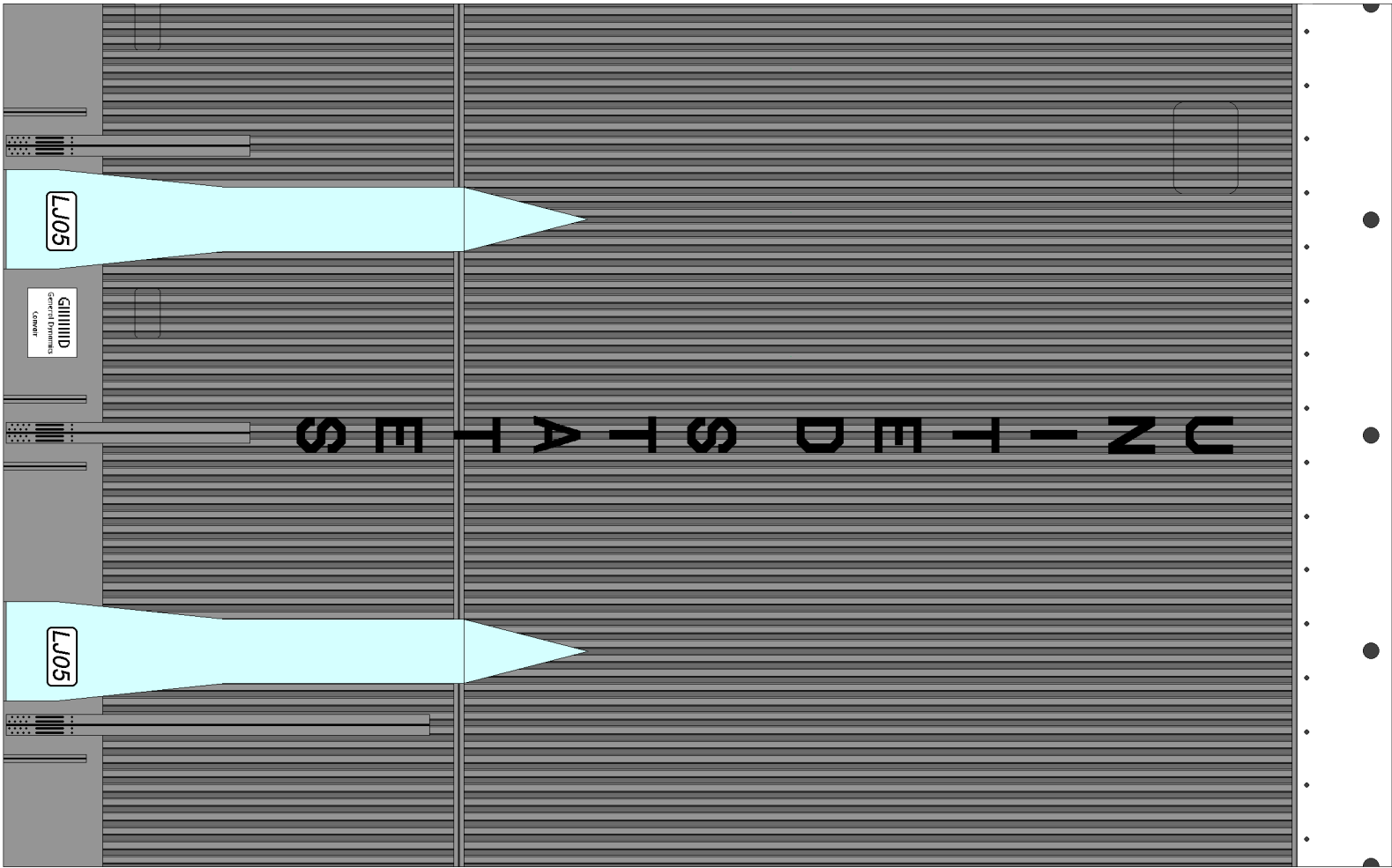

90

LJ05

GLIMMID
General Dynamics
LAWRENCE

180

LJ01

LJ05

270

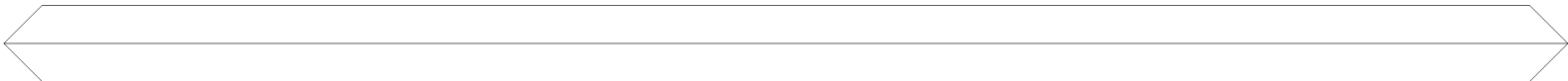

Little Joe 2

Little Joe 2

270

LJ02

0

90

LJ05

LJ05

SECRET-NC

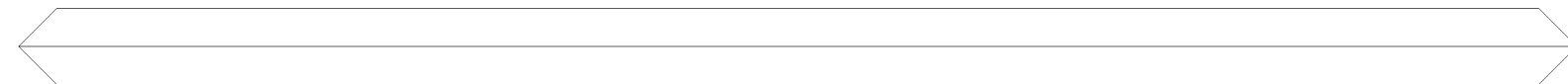

A

B

glue to cardstock

A

B

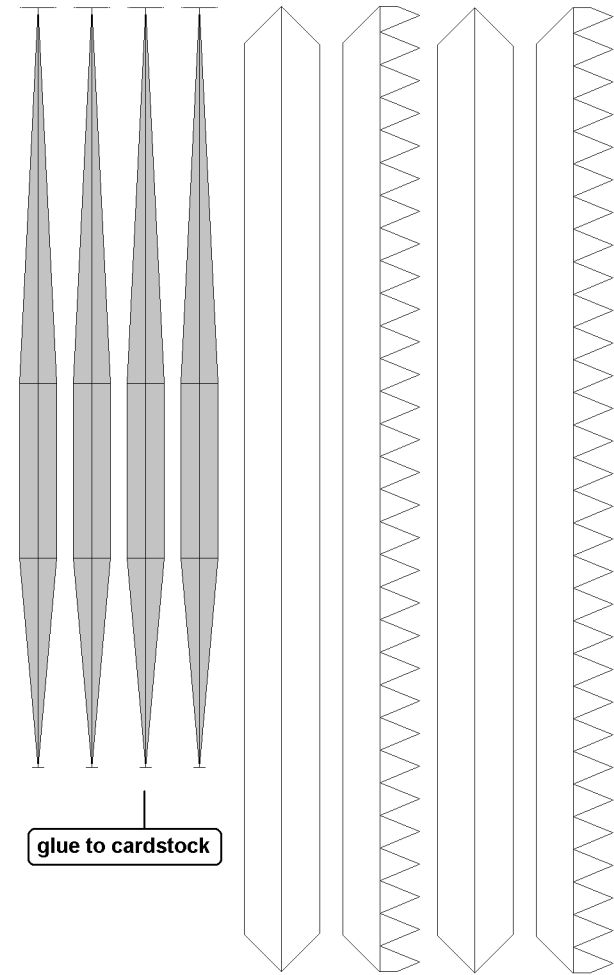
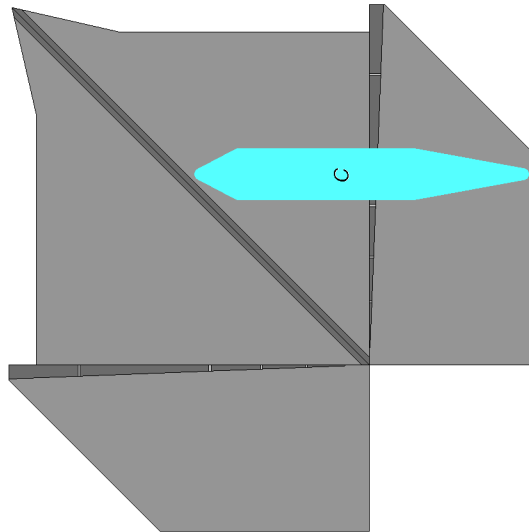
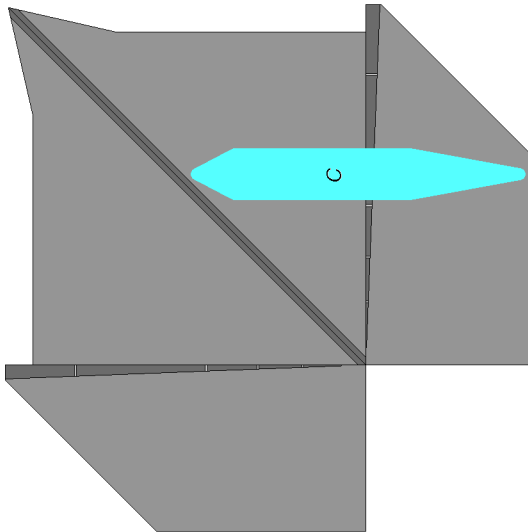
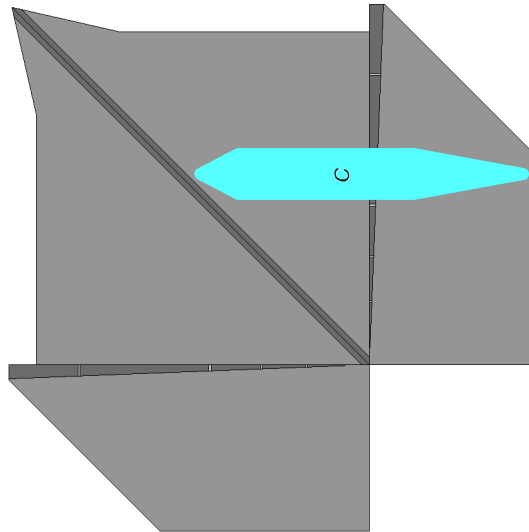
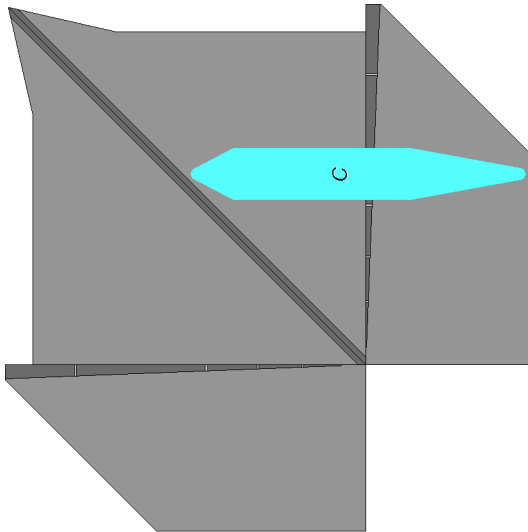

Little Joe 2

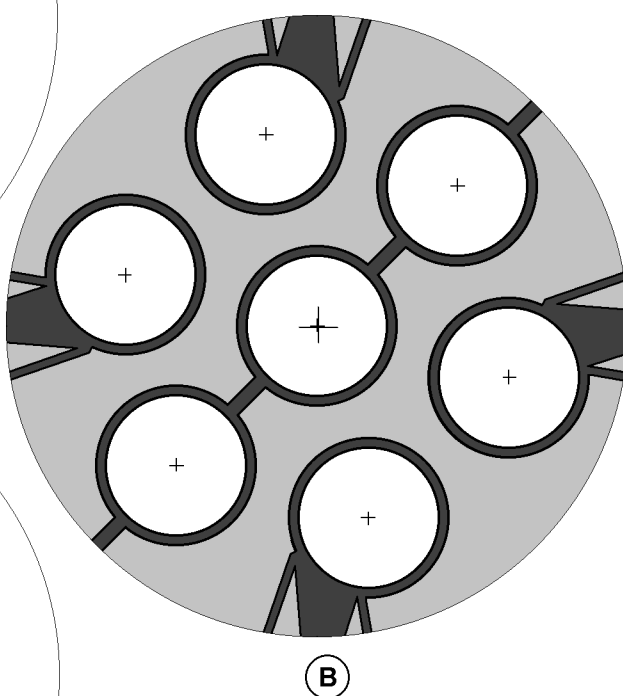
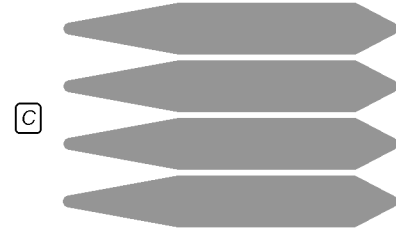
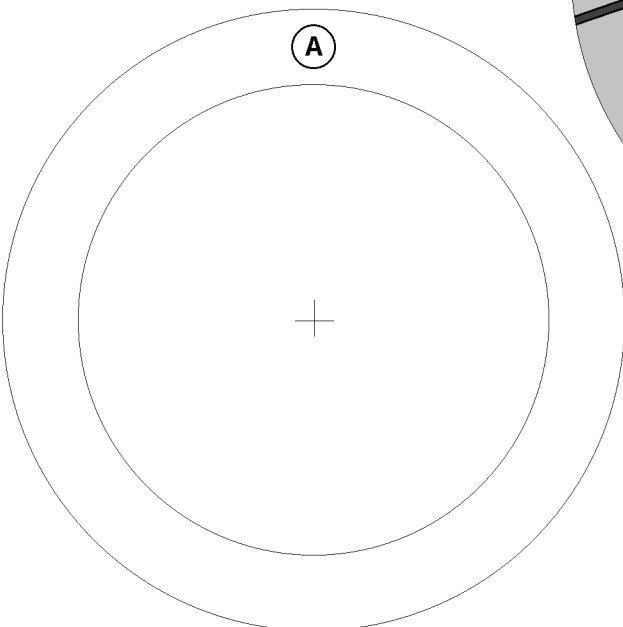
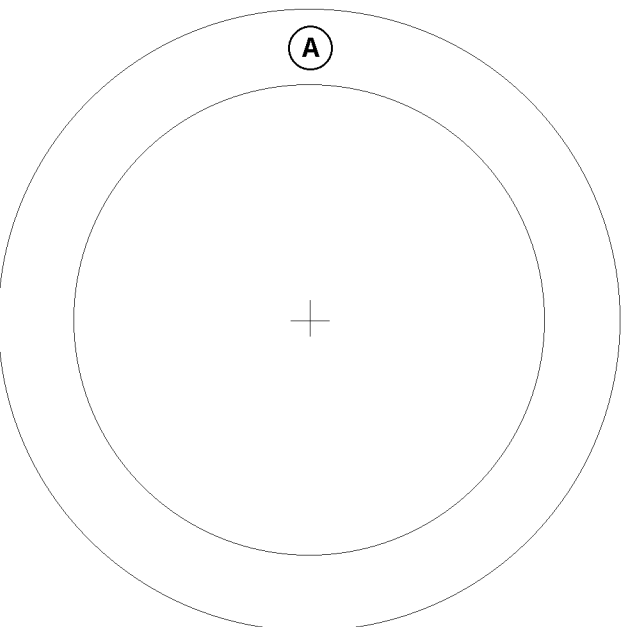
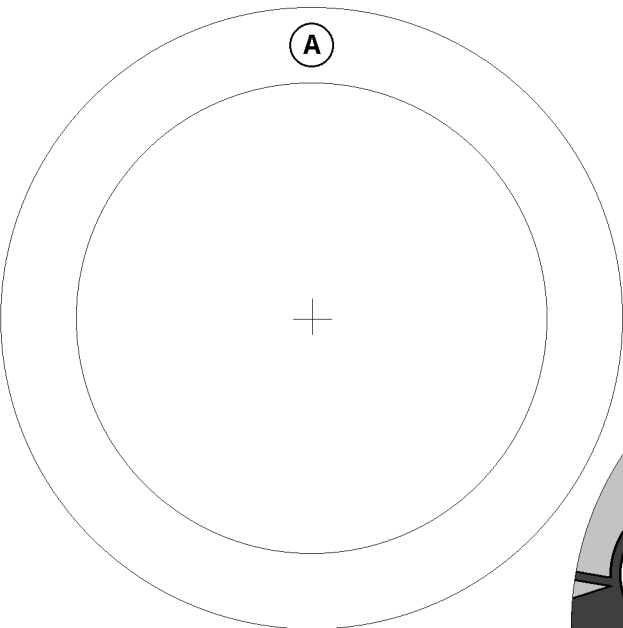
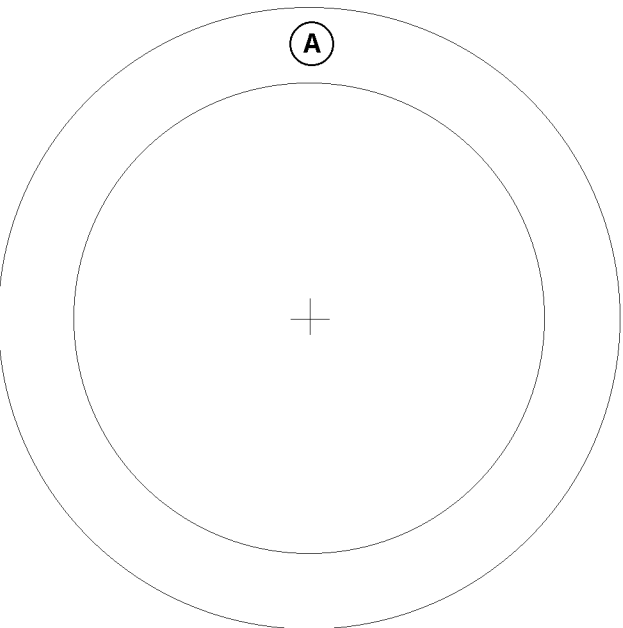

glue everything on this page to cardstock

Little Joe 2

outboard engines (glue with seam to the outside)

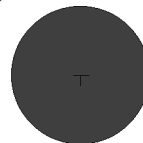
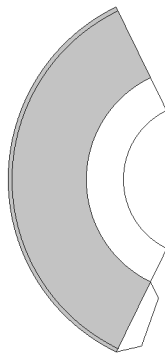
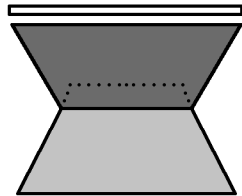
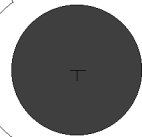
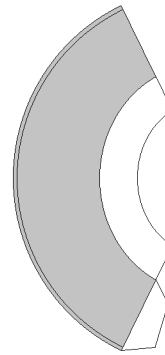
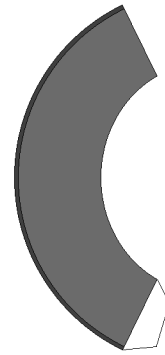
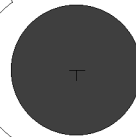
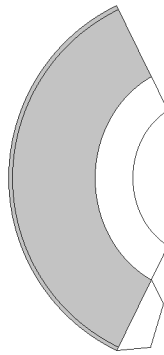
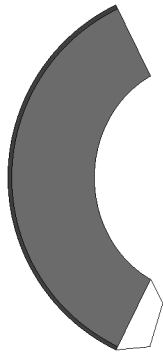
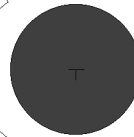
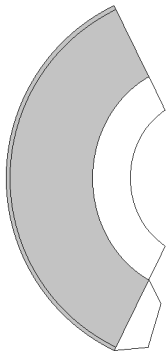
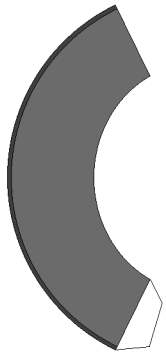
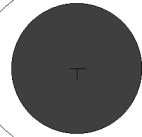
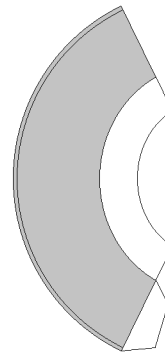
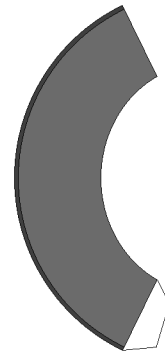
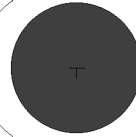
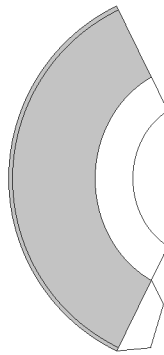
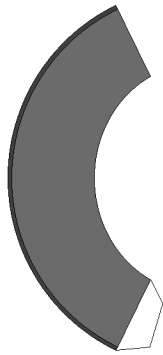
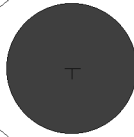
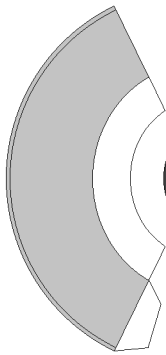
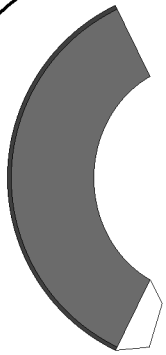

center engine

glue all the disks to cardstock

Little Joe 2

Apollo+escape-tower

